

## DCD01-BPCF 全铜内螺纹直通

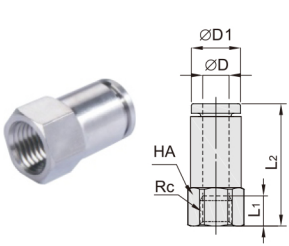

型号	ΦD	Rc	L <sub>1</sub>	L <sub>2</sub>	ΦD1	HA
DCD01-BPCF04-M5	4	M5	5.5	20	8	8
DCD01-BPCF04-01		Rc1/8	8.5	23	8.5	14
DCD01-BPCF04-02		Rc1/4	11	25.5		17
DCD01-BPCF06-M5	6	M5	5.5	25		12
DCD01-BPCF06-01		Rc1/8	8.5	28	12	14
DCD01-BPCF06-02		Rc1/4	11	30.5		17
DCD01-BPCF06-03	Rc3/8	12	31.5	21		
DCD01-BPCF06-04	8	Rc1/2	14	33.5	14	24
DCD01-BPCF08-01		Rc1/8	8.5	29		14
DCD01-BPCF08-02		Rc1/4	11	31.5		17

型号	ΦD	Rc	L <sub>1</sub>	L <sub>2</sub>	ΦD1	HA
DCD01-BPCF08-03	8	Rc3/8	12	32.5	14	21
DCD01-BPCF08-04		Rc1/2	14	34.5		24
DCD01-BPCF10-01		10	Rc1/8	8.5		31
DCD01-BPCF10-02	Rc1/4		11	33.5	21	
DCD01-BPCF10-03	Rc3/8		12	34.5	24	
DCD01-BPCF10-04	12	Rc1/2	14	36.5	12	18
DCD01-BPCF12-02		Rc1/4	11	35		19
DCD01-BPCF12-03		Rc3/8	12	36		21
DCD01-BPCF12-04	12	Rc1/2	14	38	12	24
		Rc1/2	14	38		24

## DCD02-BPL 全铜L型螺纹弯头

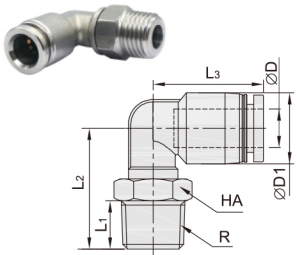

型号	ΦD	R	L <sub>1</sub>	L <sub>2</sub>	L <sub>3</sub>	ΦD1	HA
DCD02-BPL04-M5	4	M5	3.5	16	18.5	8.5	10
DCD02-BPL04-01		R1/8	7.5	19.5			
DCD02-BPL04-02		R1/4	9.5	21.5			
DCD02-BPL06-M5	6	M5	3.5	16	23.5	12	14
DCD02-BPL06-01		R1/8	7.5	19.5			
DCD02-BPL06-02		R1/4	9.5	21.5			
DCD02-BPL06-03	8	R3/8	10.5	23.5	25.7	14	14
DCD02-BPL06-04		R1/2	13.5	26.5			
DCD02-BPL08-01		R1/8	7.5	21			
DCD02-BPL08-02	8	R1/4	9.5	23	25.7	14	14
		R1/4	9.5	23			

型号	ΦD	R	L <sub>1</sub>	L <sub>2</sub>	L <sub>3</sub>	ΦD1	HA
DCD02-BPL08-03	8	R3/8	10.5	24.5	25.7	14	17
DCD02-BPL08-04		R1/2	13.5	27.5			
DCD02-BPL10-01		10	R1/8	7.5			
DCD02-BPL10-02	R1/4		9.5	24.5			
DCD02-BPL10-03	R3/8		10.5	26			
DCD02-BPL10-04	12	R1/2	13.5	29	30.7	18	21
DCD02-BPL12-02		R1/4	9.5	26			
DCD02-BPL12-03		R3/8	10.5	27			
DCD02-BPL12-04	12	R1/2	13.5	30	30.7	18	21
		R1/2	13.5	30			

## DCD03-BPB 全铜螺纹正三通

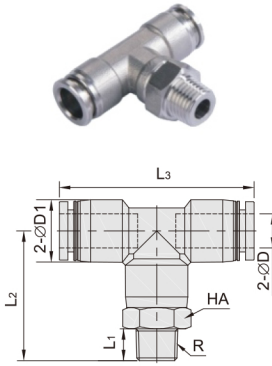

型号	ΦD	R	L <sub>1</sub>	L <sub>2</sub>	L <sub>3</sub>	ΦD1	HA
DCD03-BPB04-M5	4	M5	3.5	16	37	8.5	10
DCD03-BPB04-01		R1/8	7.5	19.5			
DCD03-BPB04-02		R1/4	9.5	21.5			
DCD03-BPB06-M5	6	M5	3.5	17	44	12	10
DCD03-BPB06-01		R1/8	7.5	20.5			
DCD03-BPB06-02		R1/4	9.5	22.5			
DCD03-BPB06-03	8	R3/8	10.5	24.5	50.5	14	12
DCD03-BPB06-04		R1/2	13.5	27.5			
DCD03-BPB08-01		R1/8	7.5	21.5			
DCD03-BPB08-02	8	R1/4	9.5	23.5	50.5	14	14
DCD03-BPB08-03		R3/8	10.5	25			
DCD03-BPB08-04		R1/2	13.5	26			
DCD03-BPB10-01	10	R1/8	7.5	23	64	16	14
DCD03-BPB10-02		R1/4	9.5	25			
DCD03-BPB10-03		R3/8	10.5	26.5			
DCD03-BPB10-04	12	R1/2	13.5	29.5	66.5	18	17
DCD03-BPB12-02		R1/4	9.5	26.5			
DCD03-BPB12-03		R3/8	10.5	27.5			
DCD03-BPB12-04	12	R1/2	13.5	30.5	66.5	18	21
		R1/2	13.5	30.5			

## DCD04-BPU 全铜直通

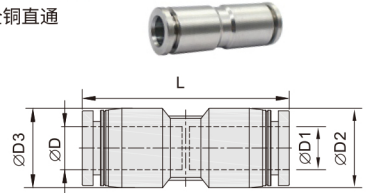

型号	ΦD	ΦD1	ΦD2	ΦD3	L
DCD04-BPU04	4	4	8.5	8.5	30.3
DCD04-BPU06	6	6	12	12	39
DCD04-BPU08	8	8	14	14	41.4
DCD04-BPU10	10	10	16	16	45.3
DCD04-BPU12	12	12	18	18	49
DCD04-BPU06-04	6	4	8.5	12	35
DCD04-BPU08-06	8	6	12	14	40.3
DCD04-BPU10-08	10	8	14	16	43.3
DCD04-BPU12-10	12	10	16	18	47

## DCD05-BPV 全铜弯头

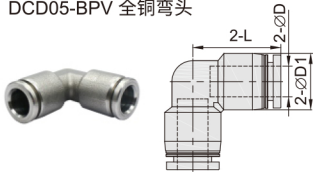

型号	ΦD	ΦD1	L
DCD05-BPV04	4	8.5	18.5
DCD05-BPV06	6	12	25
DCD05-BPV08	8	14	27.2
DCD05-BPV10	10	16	32
DCD05-BPV12	12	18	33.2

## DCD06-BPZ 全铜四通

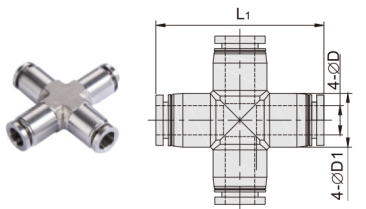

型号	ΦD	ΦD1	L <sub>1</sub>
DCD06-BPZ04	4	8.5	35
DCD06-BPZ06	6	12	48.5
DCD06-BPZ08	8	14	54
DCD06-BPZ10	10	16	58
DCD06-BPZ12	12	18	63.5

## DCD07-BPE 全铜正三通

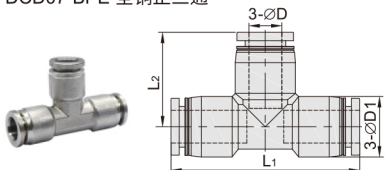

型号	ΦD	ΦD1	L <sub>1</sub>	L <sub>2</sub>
DCD07-BPE04	4	8.5	35	17.5
DCD07-BPE06	6	12	50	25
DCD07-BPE08	8	14	54.4	27.2
DCD07-BPE10	10	16	64	32
DCD07-BPE12	12	18	66.4	33.2