

# 调心球轴承 ◀ 标准型/经济·标准·进口

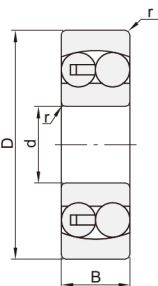

代码	类型	轴承类型代码	轴承精度	后置代码	轴承材质	
					国标	相当
BSA01	圆柱孔型	1	GB/T 307.1 6级	A(外圈引导)	GCr15	SUJ2
		2		TN(工程塑料模注保持架)		
	圆锥孔型	1		A(外圈引导)		
		2		TN(工程塑料模注保持架) K(圆锥孔型, 锥度为1: 12)		

圆柱孔型



(安装图)

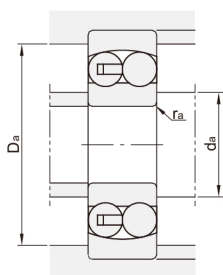

圆锥孔型

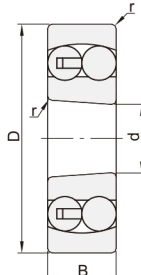

(安装图)

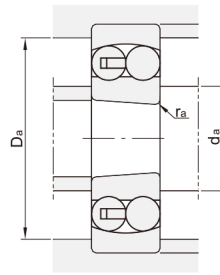

代码	型号		d	D	B	r (min)	额定载荷		极限转速(r/min)		安装尺寸			重量值kg (参考)
	圆柱孔型	圆锥孔型					Cr(动)KN	Cor(静)KN	脂润滑	油润滑	da(min.)	Da(max.)	ra(max.)	
BSA01	1200ATN	-	10	30	9	0.6	5.06	1.18	24000	30000	14.0	26.0	0.6	0.0336
	1201ATN		12	32	10		5.58	1.48	22000	28000	16.0	28.0		0.0411
	1202ATN		15	35	11	7.47	2.01	19000	24000	19.0	31.0	0.0497		
	1302ATN		42	13	1.0	9.52	2.63	17000	20000	20.0	37.0	0.0966		
	1303ATN	1204AKTN	17	47	14	0.6	11.80	3.33	14000	17000	22.0	42.0	1.0	0.1310
	1204ATN						12.70	3.40	15000	18000	25.0			0.1160
	1205ATN	1205AKTN	25	52	15	1.0	14.30	4.00	13000	16000	30.0	47.0	1.0	0.1390
	2205ATN	-			18	16.00	4.47	11000	14000	31.5	55.5	0.1580		
	1305ATN	1206AKTN	30	62	17	1.1	18.10	6.00	9500	12000	35.0	57.0	1.0	0.2500
	1206ATN				16	15.60	4.65	10000	13000	41.5	65.5	0.2190		
	2206ATN				20	23.80	6.58	9500	12000	46.5	73.5	0.2501		
	1207ATN	1207AKTN	35	72	17	1.1	18.00	6.23	9000	11000	41.5	65.5	1.0	0.3050
	2207ATN	-			23		30.50	8.72	8500	10000				0.3850
	1208ATN	1308AKTN	40	80	18	1.5	18.50	6.95	8500	10000	46.5	73.5	1.5	0.3930
	2208ATN				23		31.80	10.10	7500	9000				0.4880
	1308ATN	23	33.80	11.40	6700	8000	48.0	82.0	1.5	0.6730				
	-	2308AKTN	33	54.20	15.90	6300	7500	0.8970						
	1309ATN	1209AKTN	45	85	19	1.1	21.70	9.56	7500	9000	51.5	78.5	1.0	0.4730
	2209ATN	-			23	32.00	10.60	7000	8500	55.5	0.5260			
	1309ATN	1309AKTN	50	90	25	1.5	38.00	13.40	6300	7500	53.0	92.0	1.5	0.9320
	1210ATN	-			20	26.50	9.15	7000	8500	56.5	83.5	1.0		0.5250
	2210ATN	-	23	33.60	11.30	6300	7500	59.0	101.0	2.0	1.1700			
	1310ATN	-	27	43.30	14.00	5600	6700	1.6500						
	2310ATN	-	40	63.70	20.00	5300	6300							

1Kg=9.81N



请按图示订货

## BSA01-1200ATN

型号		d	D
代码	轴承型号		
BSA01	1200ATN	10	30



交期Delivery

**3** 天 发货

○ 本产品发货时间不含周日

轴承 / 关节轴承 27