

铜合金直柱式无油衬套 ◀ 标准型/薄壁型 · 内径F7外径m6

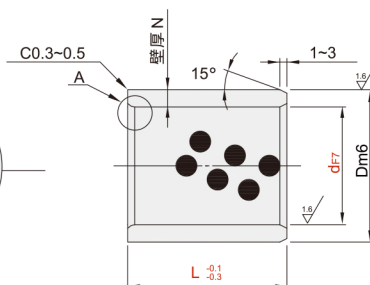

代码	类型	材质	内径公差	外径公差
FCE01	直柱式	标准型	F7	m6
FCE02		薄壁型		
		高力黄铜(SP2) (镶嵌固体润滑剂)		

FCE01 标准型同径F7外径m6型

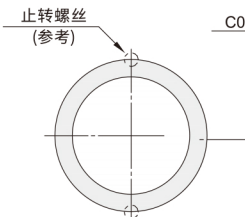
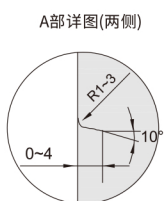

FCE02 薄壁型同径F7外径m6型

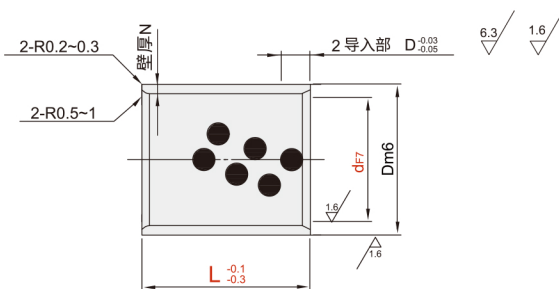
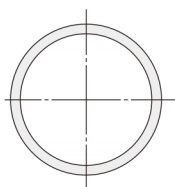

无油衬套
24

型式		L				FCE01		FCE02									
代码	df7					Dm6	壁厚(N)	Dm6	壁厚(N)								
标准型 FCE01	5	+0.022	8	10	12	15	16	20	9	+0.015	2	7	+0.015 +0.006	1			
	6	+0.010	8	10	12	15	16	20	25	10		+0.006			8		
	8	+0.028	8	10	12	15	16	20	25	30		12			10		
	10	+0.013	8	10	12	15	16	20	25	30		35			14	+0.018 +0.007	12
	12	+0.034 +0.016	8	10	12	15	16	20	25	30	35	40	18	15	+0.018 +0.007	1.5	
	13		10	12	15	16	20	25	30	35	40	19	16				
	15		10	12	15	16	20	25	30	35	40	50	21	18			
	16		10	12	15	16	20	25	30	35	40	50	22	20	+0.021 +0.008	2	
	18		10	12	15	16	20	25	30	35	40	50	24	22	+0.021 +0.008		
	20		10	12	15	16	20	25	30	35	40	50	60	70	28		4
20A	10	12	15	16	20	25	30	35	40	50	60	70	30	5	\		
25	+0.041 +0.020	12	15	16	20	25	30	35	40	50	60	70	33	4	29	+0.025 +0.009	2.5
25A	12	15	16	20	25	30	35	40	50	60	70	80	35	5	\		
30	12	15	16	20	25	30	35	40	50	60	70	80	38	4	34	+0.030 +0.011	
35	+0.050 +0.025	16	20	25	30	35	40	50	60	70	80	44	4.5	40	5	45	
40		20	25	30	35	40	50	60	70	80	50	6	55	+0.035 +0.011			
50	25	30	35	40	50	60	70	80	62	+0.030 +0.011	7.5	\					
60	+0.060 +0.030	40	50	60	70	80	75	8									
80	50	60	70	80	96	+0.035 +0.013											
100	+0.071 +0.036	70	80	100	120		10										



请按图示订货

■ FCE01-d5-L20

型号		L	
代码	d		
FCE01	5	+0.022	8 10 12 15 16 20



交期Delivery

4天 发货

○本产品发货时间不含周日