

夹具用衬套 ◀ L尺寸选择型 无肩型



无肩型		L尺寸	公差等级	材质		淬火硬度	表面处理
标准型	薄壁型			国标	相当		
MEM01	MEM07	选择型	Pp6	9CrWMn	SKS3	58HRC~	/
MEM02	MEM08			9Cr18Mo	SUS440C	48~53HRC	无电解镀锌
MEM03	MEM09			9CrWMn	SKS3	58HRC~	/
MEM04	MEM10		Pm6	9Cr18Mo	SUS440C	48~53HRC	无电解镀锌
MEM05	MEM11			9CrWMn	SKS3	58HRC~	/
MEM06	MEM12			9Cr18Mo	SUS440C	48~53HRC	无电解镀锌

无肩型-标准型
MEM01/02/03/04/05/06

无肩型-薄壁型
MEM07/08/09/10/11/12

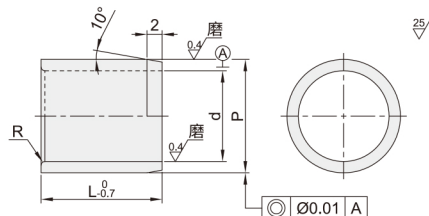
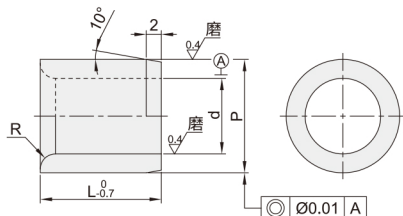

■ 标准型

型号		d公差			L	R	H	T	P	P公差						
代码	d	无表面处理	无电解镀锌	H7						p6	m6					
Pp6 Pm6 MEM01 MEM04 MEM02 MEM05 MEM03 MEM06	2	+0.008 +0.002	+0.010 0									H7	5 6 8 10 12	0.8	9	2.5
	3	+0.012 +0.004	+0.012 0	G6	8 10 12 15 16 20	1.0	3	10	+0.012	+0.004						
	4								+0.014 +0.005	+0.014 +0.005	G6					
	5	+0.017 +0.006	+0.017 +0.006									G6	10 12 15 16 20 25 30	3.0	5	14
	6			+0.020 +0.007	+0.020 +0.007	G6	12 15 16 20 25 30 35	3.0	6	16						
	8	+0.020 +0.007	+0.020 +0.007								G6					
	10			+0.035 +0.022	+0.035 +0.022							G6	15 16 20 25 30	3.0	6	20
	12	+0.042 +0.026	+0.042 +0.026			G6	15 16 20 25 30 35	3.0	6	22						
	15			+0.042 +0.026	+0.042 +0.026						G6					
	16	+0.042 +0.026	+0.042 +0.026									G6	15 16 20 25 30 35	3.0	6	26
	20			+0.042 +0.026	+0.042 +0.026	G6	15 16 20 25 30 35	3.0	6	28						
	25	+0.042 +0.026	+0.042 +0.026								G6					

■ 薄壁型

型号		d公差			L	R	H	T	P	P公差							
代码	d	无表面处理	无电解镀锌	H7						p6	m6						
Pp6 Pm6 MEM07 MEM10 MEM08 MEM11 MEM09 MEM12	3	+0.008 +0.002	+0.010 0									H7	6 8 10 12	0.5	9	2.5	5
	4	+0.012 +0.004	+0.012 0	G6	6 8 10 12 15 16	1.0	3	4	6	+0.012	+0.004						
	5									+0.014 +0.005	+0.014 +0.005						
	6	+0.017 +0.006	+0.017 +0.006									G6	8 10 12 15 16 20	3.0	6	8	+0.015
	8			+0.020 +0.007	+0.020 +0.007	G6	8 10 12 15 16 20	3.0	6	9	+0.029						+0.018
	10	+0.035 +0.022	+0.035 +0.022								G6						10 12 15 16 20
	12			+0.042 +0.026	+0.042 +0.026							G6	10 12 15 16 20	3.0	6	11	
	15	+0.042 +0.026	+0.042 +0.026			G6	10 12 15 16 20 25	3.0	6	12							
	16			+0.042 +0.026	+0.042 +0.026						G6						10 12 15 16 20 25
	20	+0.042 +0.026	+0.042 +0.026									G6	16 20 25	3.0	6	14	
	25			+0.042 +0.026	+0.042 +0.026	G6	16 20 25	3.0	6	15							



请按图示订货

MEM01-d2-L6

型号		L
代码	d	
MEM01	2	6



交期Delivery

5天

发货

○本产品发货时间不含周日