

# 搭扣 ▶ 普通型/中载型

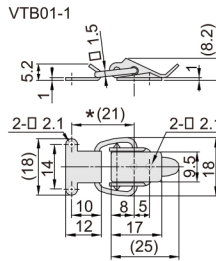

代码	类型	材质	表面处理
VTB01	普通型	不锈钢	滚磨
VTC01	中载型		震抛



推荐安装孔间距

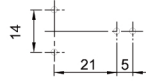

推荐安装螺丝: 十字孔圆头小螺丝M2

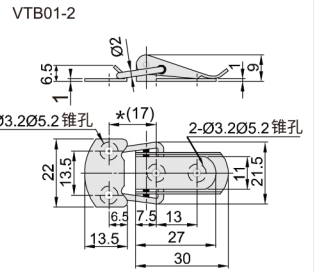

推荐安装孔间距



VTC01-0

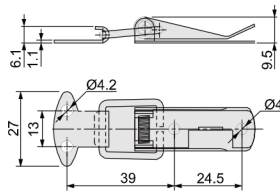

推荐安装孔间距

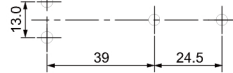

VTC01-1

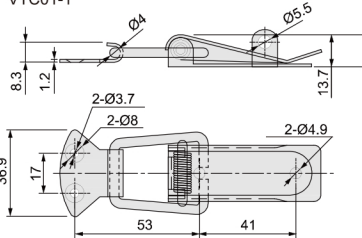

推荐安装孔间距

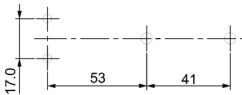

VTC01-2

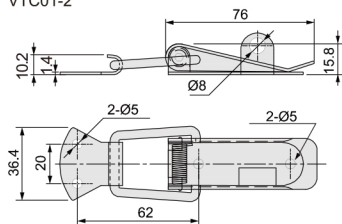

推荐安装孔间距

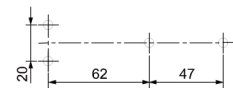

VTB01-3

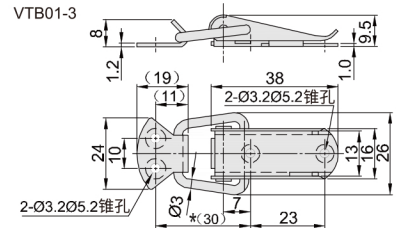

推荐安装孔间距

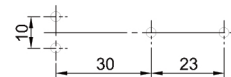

VTB01-4

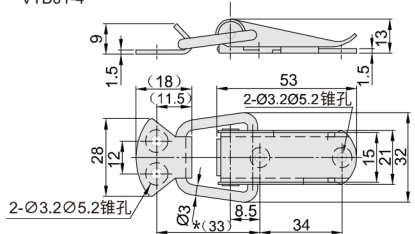

推荐安装孔间距

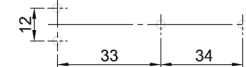

球形扣  
搭扣/磁力扣  
65

型号		保持力(kgf)	重量(g)
代码	规格		
VTB01	1	49	34
	2	78	79
	3	98	75
	4	147	30

代码	规格
VTC01	0
	1
	2



## ■ VTC01-1

型号

代码	规格
VTC01	0
	1
	2



交期Delivery

**4天** 发货

○本产品发货时间不含周日